

PRODUCT SPECIFICATION

# SILICONE LED STRIP

ELITE SERIES

CCT Option



YELLOW AND GREY



Version 1.0 | [www.yellowgrey.co.uk](http://www.yellowgrey.co.uk)

- Made with a Dow Chemical SILASTIC™ ET-7021 silicone rubber, which provides high transparency and strength
- Environmental protection grade silicone material
- integrated extrusion moulding process
- Unique optical light distribution structure design, uniform lighting
- surface and no shadow;
- IP67 protection level, salt solution resistance, acids & alkalis and UV resistance
- Excellent toughness, simple and stylish appearance, delicate and unique
- Up to 3 years warranty, working life ≥50000 hours



Options : SIDE VIEW

Options : TOP VIEW

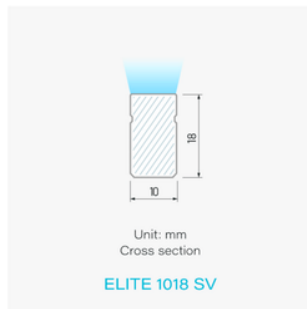
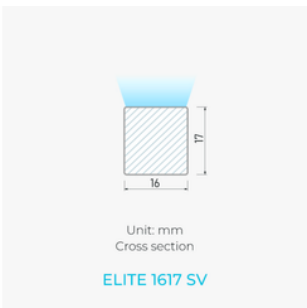
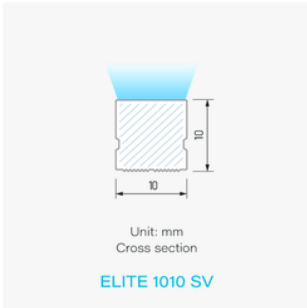

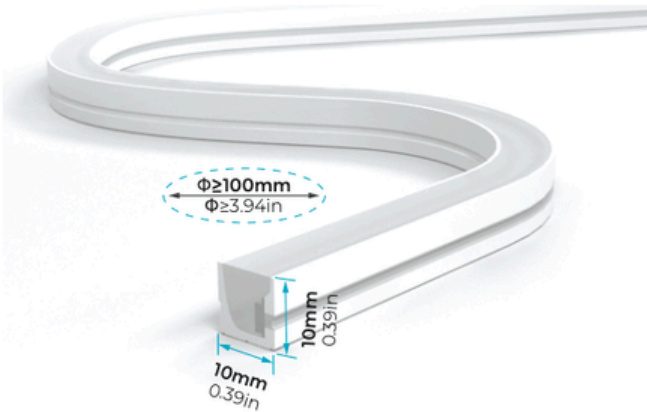

ELITE is a silicone co-extrusion IP67 neon offers UV resistance, chemical stability, and against abrasion. It supports freely configurable in length by filed cutting and assembly with quick endcap.

Horizontal bending.  
Up to 5m/16.4ft run length from the single power feed. Dust-free matte finish optional.

Light Distribution Curve

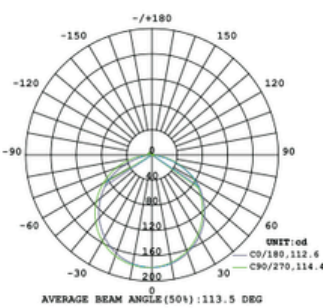

Average Illuminance

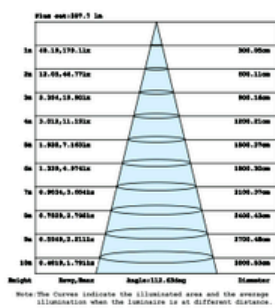

Accessories

Aluminium Profile



Clips



Cable PVC



Cutting Tool



IK10

PC Profile



Connector



Cable Silicone



VHB Tape

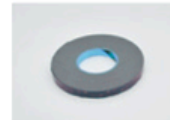

Protection



Dirt Resistant



One Bin

Curved Profile



Silicone Endcaps



Anti Siphon



Silicone



SDCM



0.5M-30M

Technical Data

Dimension	10mm x 10 mm / 0.39in x 0.39in
Voltage	DC24V
RA	>90
Dimming	Dimmable
Efficacy	63LM/W @4000K
Storage Temperature	-25~60°C / -22~140°F
Ambient Temperature	Min.-25°C Max.+55°C
Max. Production Length	30M / 98.43ft

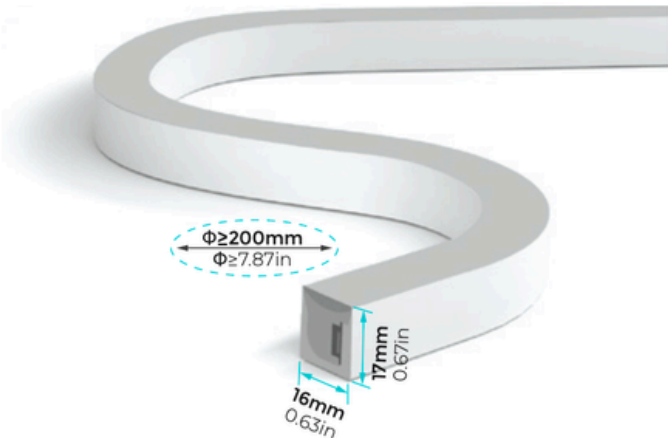

ELITE is a silicone co-extrusion IP67 neon offers UV resistance, chemical stability, and against abrasion. It supports freely configurable in length by filed cutting and assembly with quick endcap.

Horizontal bending.  
Up to 24m/78.7ft run length from the single power feed. Dust-free matte finish optional.

Light Distribution Curve

Average Illuminance

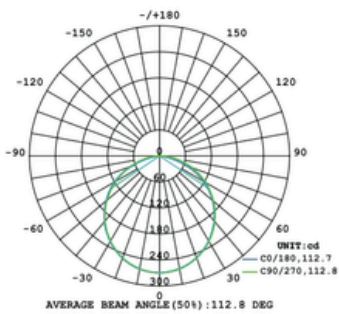

Dist	Beam Area	Average Illuminance
1m	72.42, 369.71m	360.62lm
2m	144.84, 1478.84m	495.24lm
3m	217.26, 3312.18m	363.48lm
4m	289.68, 5841.6m	272.61lm
5m	362.1, 9076.5m	208.92lm
6m	434.52, 12917.4m	162.66lm
7m	506.94, 17364.9m	131.16lm
8m	579.36, 22418.4m	108.9lm
9m	651.78, 28078.5m	92.7lm
10m	724.2, 34345.6m	81.24lm

Note: The Curves indicate the illuminated area and the average illumination when the luminance is at different distance.

Technical Data

Dimension	16mm x 17mm / 0.63in x 0.67in
Voltage	DC24V
RA	>90
Dimming	Dimmable
Efficacy	59.1LM/W @4000K
Storage Temperature	-25~60 C / -22~140 F
Ambient Temperature	Min.-25C Max.+55C
Max. Production Length	30M / 98.43ft

Accessories

Aluminium Profile

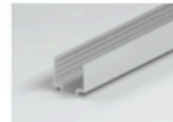

PC Profile



Curved Profile



Clips

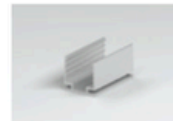

Quick Endcaps



Silicone Endcaps



Anti Siphon



Cable PVC



Cable Silicone



Cutting Tool



Connector



Silicone



IK10 Protection Dirt Resistant One Bin 3 SDCM 0.5M-30M



SKU : ELITE 1018-SIDE

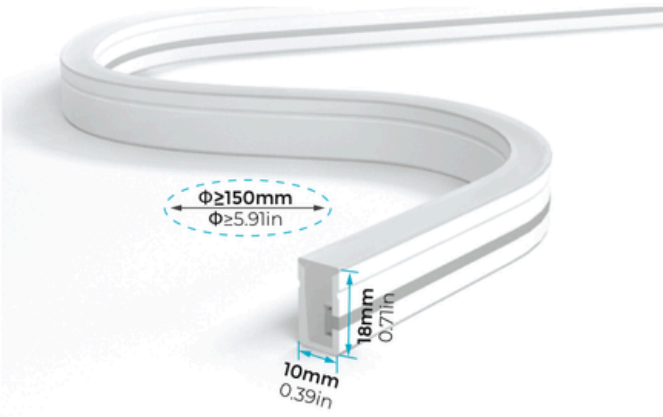

ELITE is a silicone co-extrusion IP67 neon offers UV resistance, chemical stability, and against abrasion. It supports freely configurable in length by filed cutting and assembly with quick endcap.

Horizontal bending.  
Up to 24m/78.7ft run length from the single power feed. Dust-free matte finish optional.

Light Distribution Curve

Average Illuminance

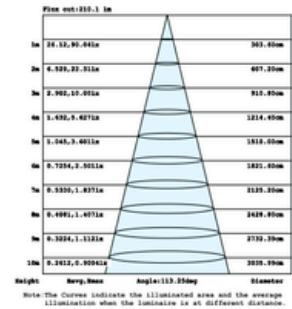
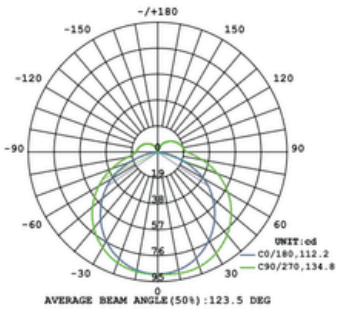

Technical Data

Dimension	10mm x 18mm / 0.39in x 0.71in
Voltage	DC24V
RA	>90
Dimming	Dimmable
Efficacy	36.9LM/W @4000K
Storage Temperature	-25~60 °C / -22~140 °F
Ambient Temperature	Min.-25°C Max.+55°C
Max. Production Length	30M / 98.43ft

Accessories

<p>Aluminium Profile</p>	<p>Clips</p>	<p>Silicone Endcaps</p>
<p>Cable PVC</p>	<p>Cable Silicone</p>	<p>Anti Siphon</p>
<p>Connector</p>	<p>Connector</p>	<p>Silicone</p>
<p>Cutting Tool</p>		

IK10	Protection	Dirt Resistant	One Bin	<b>3</b> SDCM	0.5M-30M
------	------------	----------------	---------	------------------	----------

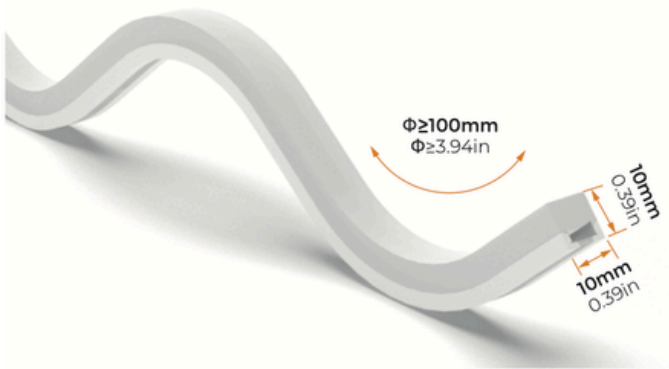
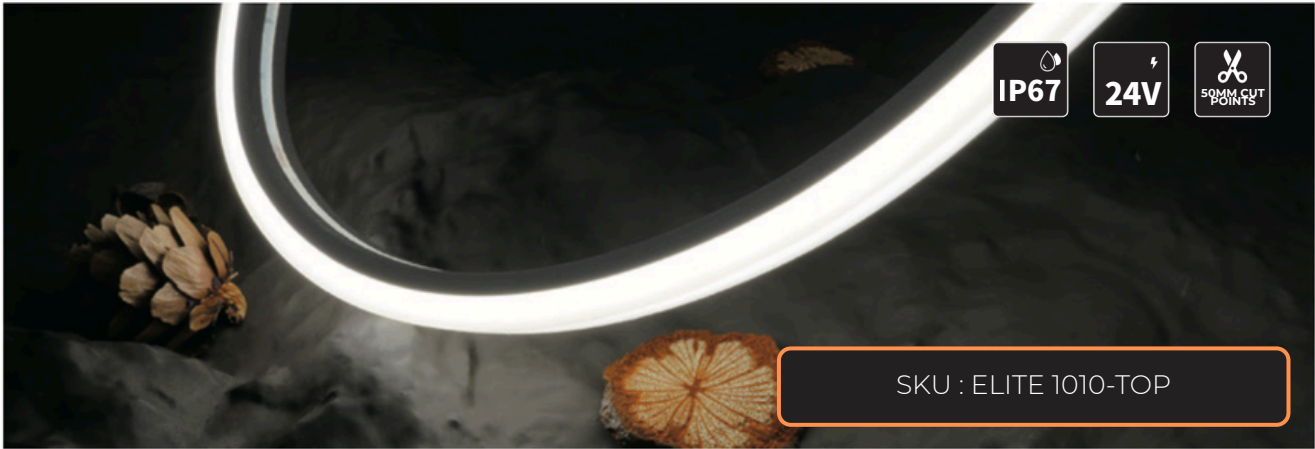

ELITE is a silicone co-extrusion IP67 neon offers UV resistance, chemical stability, and against abrasion. It supports freely configurable in length by filed cutting and assembly with quick endcap.

Vertical bending.  
Up to 5m/16.4ft run length from the single power feed. Dust-free matte finish optional.

Light Distribution Curve

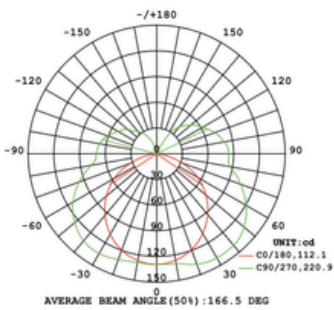

Average Illuminance

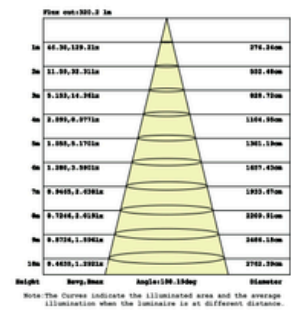

Accessories

Aluminium Profile	PC Profile	Silicone			
Clips	Curved Profile	Silicone Endcaps			
Cable PVC	Cable Silicone	Anti Siphon			
Cutting Tool	Connector	VHB Tape			
IK10	Protection	Dirt Resistant	One Bin	3 SDCM	0.5M-30M

Technical Data

Dimension	10mm x 10mm / 0.39in x 0.39in
Voltage	DC24V
RA	>90
Dimming	Dimmable
Efficacy	79LM/W @4000K
Storage Temperature	-25~60 °C / -22~140 °F
Ambient Temperature	Min.-25°C Max.+55°C
Max. Production Length	30M / 98.43ft

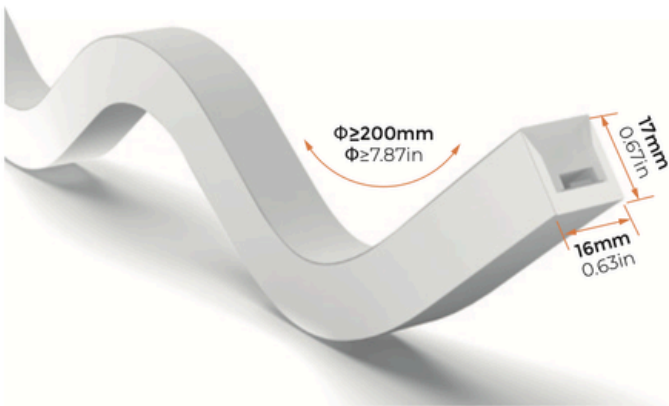
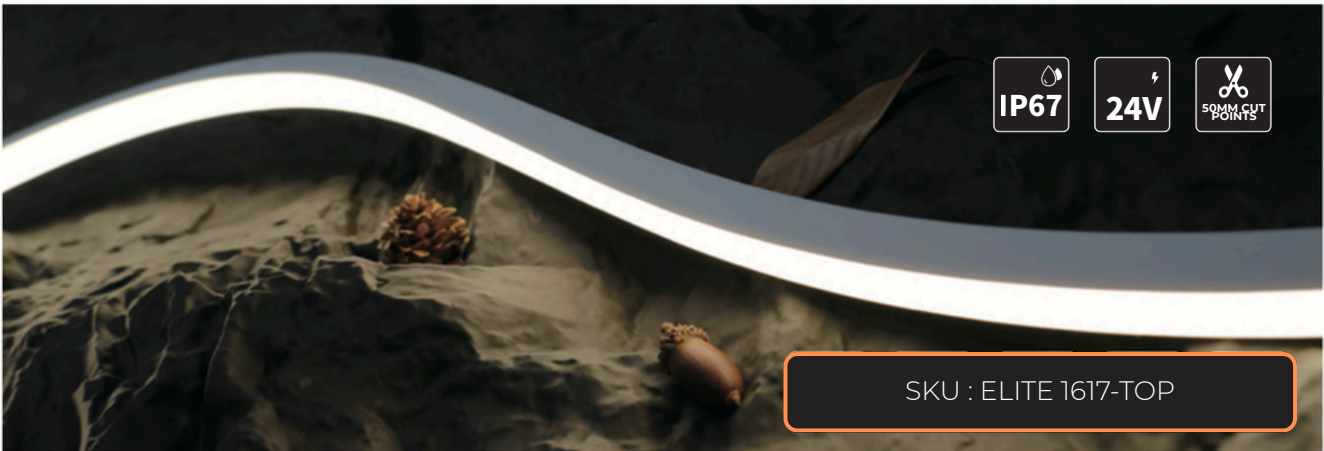

ELITE is a silicone co-extrusion IP67 neon offers UV resistance, chemical stability, and against abrasion. It supports freely configurable in length by filed cutting and assembly with quick endcap.

Vertical bending.  
Up to 24m/78.7ft run length from the single power feed. Dust-free matte finish optional.

**Light Distribution Curve**   **Average Illuminance**

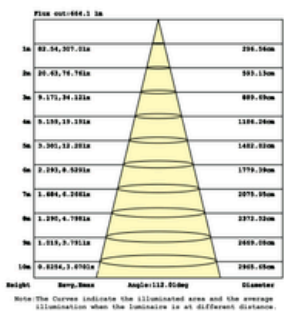
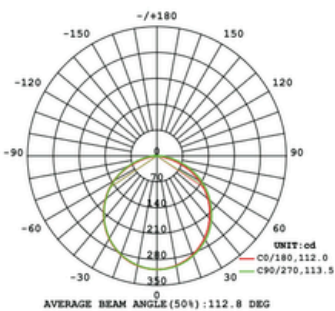

**Technical Data**

Dimension	16mm x 17mm / 0.63in x 0.67in
Voltage	DC24V
RA	>90
Dimming	Dimmable
Efficacy	69.9LM/W @4000K
Storage Temperature	-25~60 °C / -22~140 °F
Ambient Temperature	Min.-25°C Max.+55°C
Max. Production Length	30M / 98.43ft

**Accessories**

<p>Aluminium Profile</p>	<p>PC Profile</p>	<p>Curved Profile</p>
<p>Clips</p>	<p>Quick Endcaps</p>	<p>Silicone Endcaps</p>
<p>Cable PVC</p>	<p>Cable Silicone</p>	<p>Anti Siphon</p>
<p>Cutting Tool</p>	<p>Connector</p>	<p>Silicone</p>
<p>IK10</p>	<p>Protection</p>	<p>Dirt Resistant</p>
<p>One Bin</p>	<p>3 SDCM</p>	<p>0.5M-30M</p>



ELITE is a silicone co-extrusion IP67 neon offers UV resistance, chemical stability, and against abrasion. It supports freely configurable in length by filed cutting and assembly with quick endcap.

Vertical bending.  
Up to 27m/88.5ft run length from the single power feed. Dust-free matte finish optional.

Light Distribution Curve

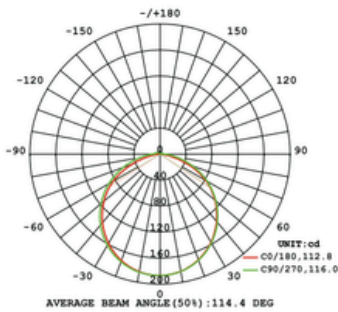

Average Illuminance

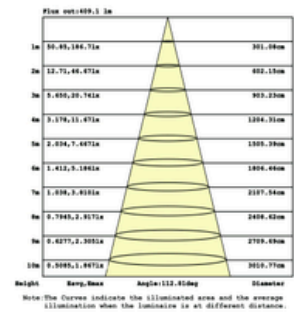

Accessories

Aluminium Profile	Clips	Silicone Endcaps
Curved Profile	Connector	Connector
Cable PVC	Cable Silicone	Anti Siphon
Cutting Tool	Silicone	

IK10 Protection Dirt Resistant One Bin 3 SDCM 0.5M-30M

Technical Data

Dimension	20mm x 20mm / 0.79in x 0.79in
Voltage	DC24V
RA	>90
Dimming	Dimmable
Efficacy	52.8LM/W @4000K
Storage Temperature	-25~60 °C / -22~140 °F
Ambient Temperature	Min.-25°C Max.+55°C
Max. Production Length	30M / 98.43ft

Wiring : Single colour

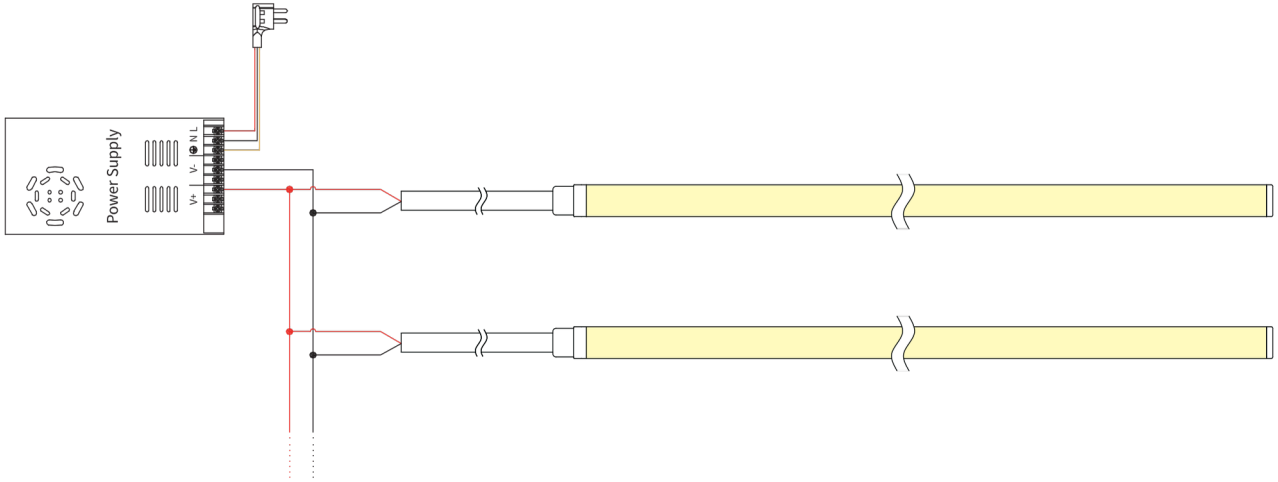

Wiring : RGB

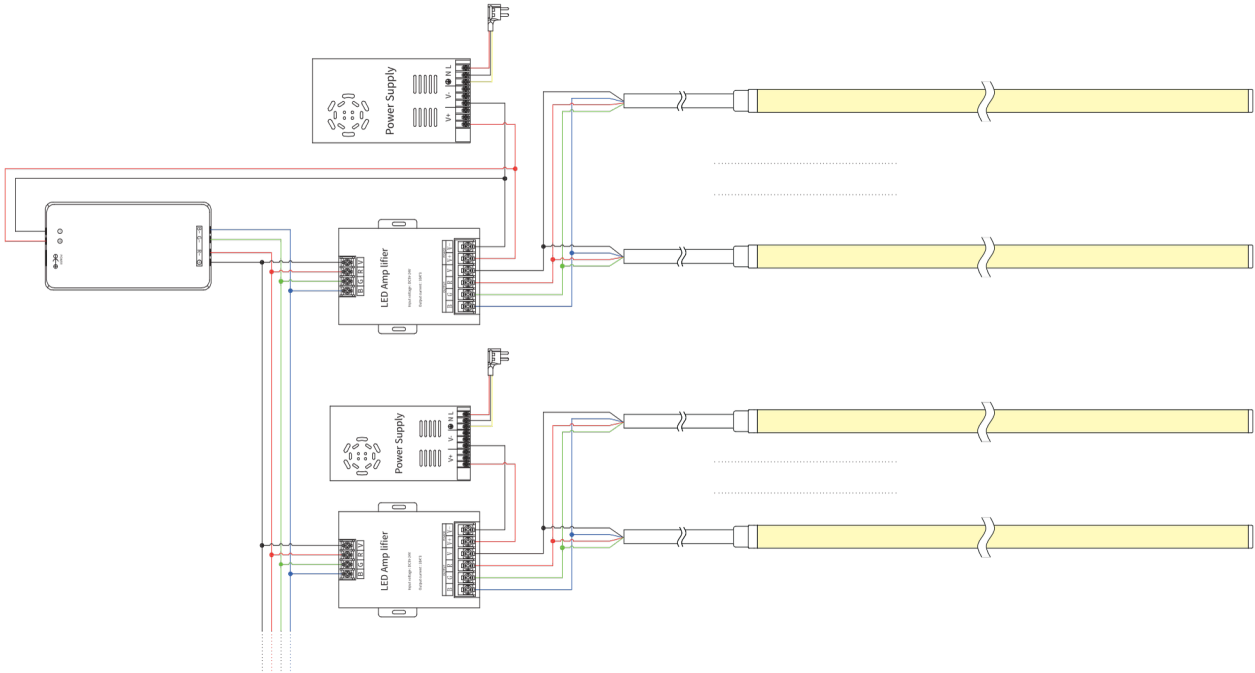

### Installation precautions

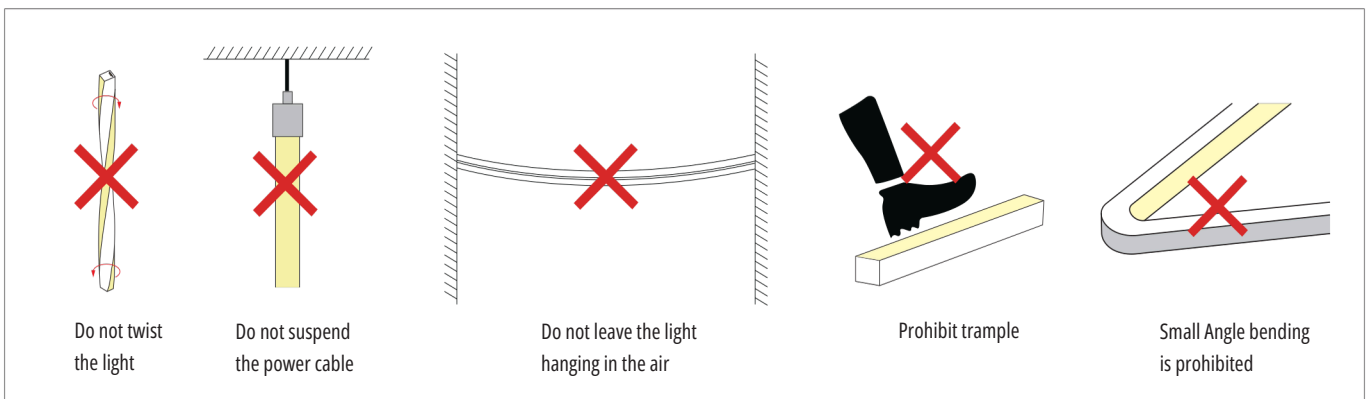
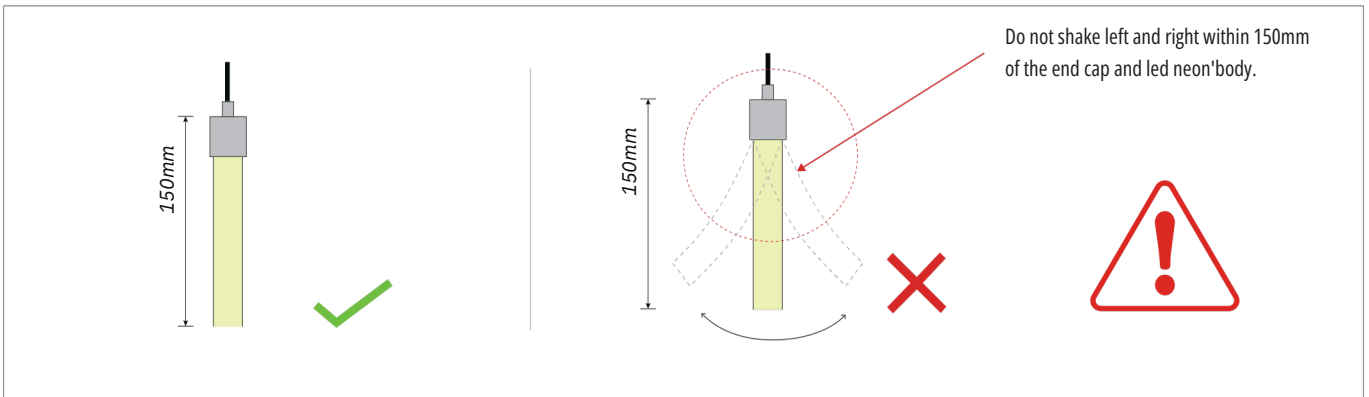

### Installation in profile

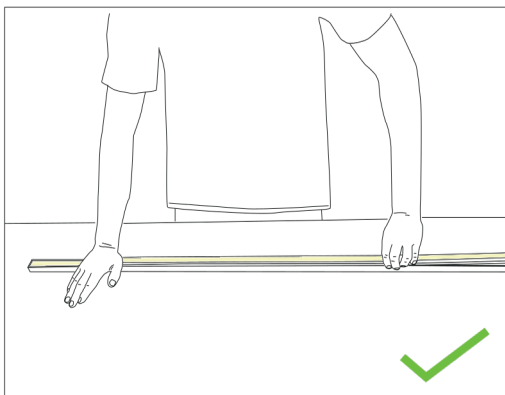

Please press the led strip with your palm to slowly insert the led strip into the groove, and gently straighten the led strip above the groove with your right hand.

Try to keep the led strip in a flat state during the installation process

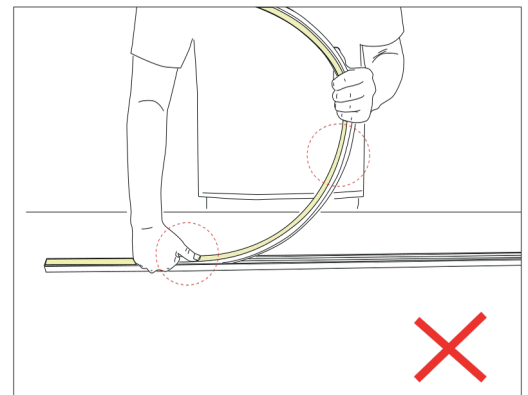

Do not press the led strip with a single finger, it is easy to damage the internal parts of the led strip.

The bent arc of the led strip should not be too large during installation

## Installation precautions: Side mounted (2 person installation)

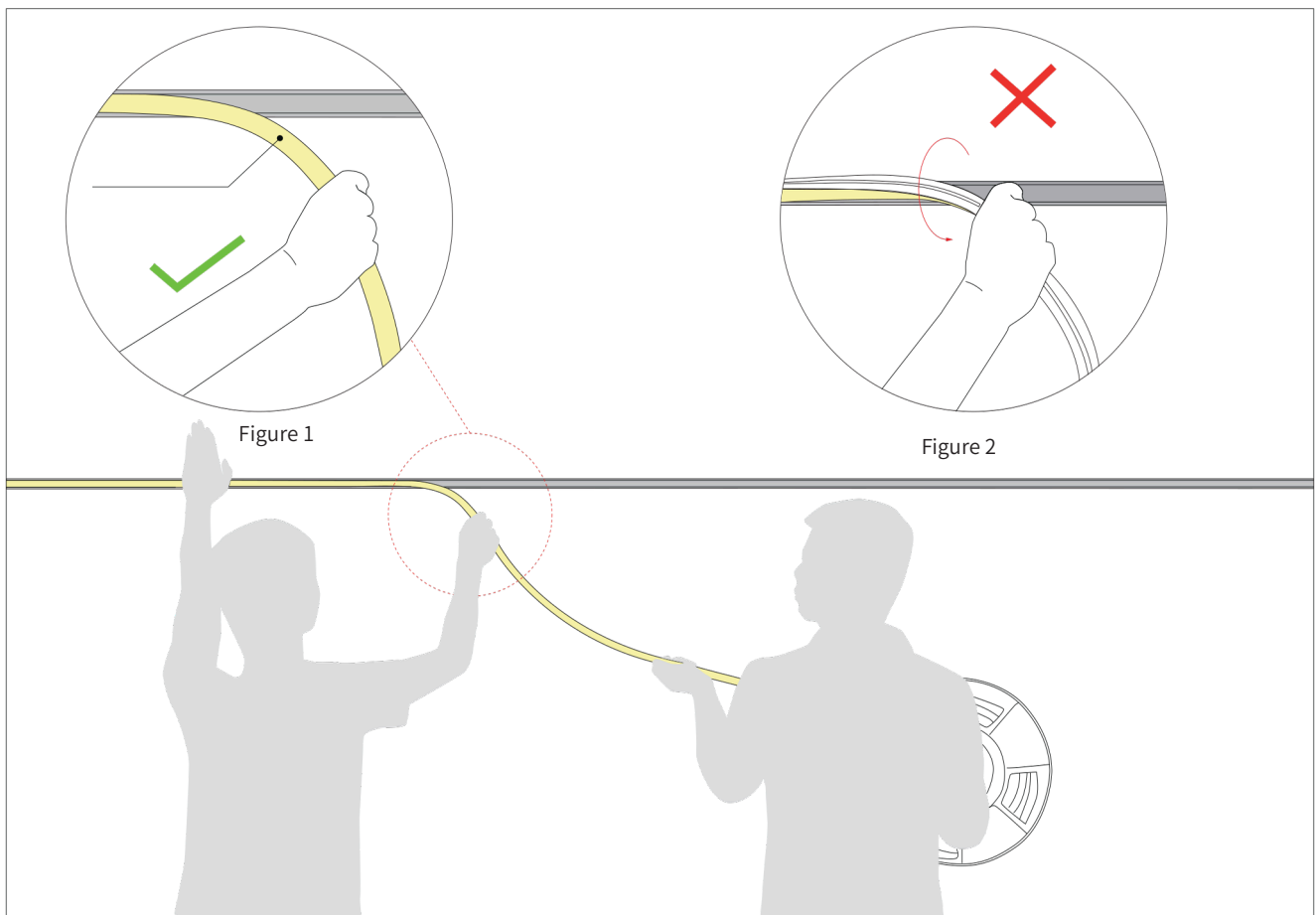
**1. Installer:**

1. Press the light with the palm of the left hand to slowly load it into the slot. Straighten the light with right hand so that it droop in the direction of your hand. See Figure 1. Side surface may not be bent or droop, See Figure 2.

**2. Assistant:**

Cooperate with the installer to lift the reel of the light, and then slowly deliver the light to installer. Do not pull or twist the light during the installation.

Installation precautions: Side mounted at height (2 person installation)

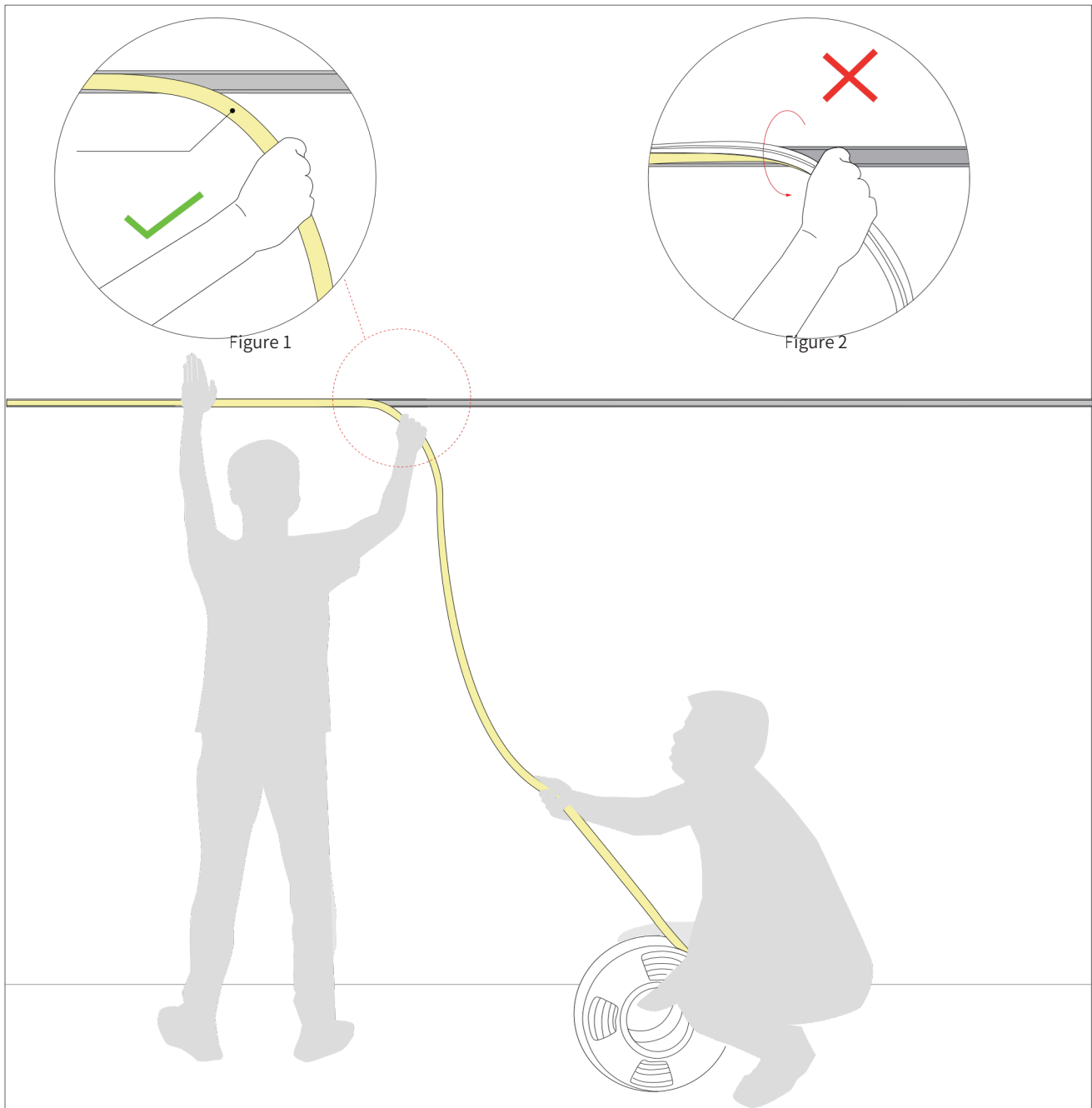

**1. Installer:**

1. Press the light with the palm of the left hand to slowly load it into the slot. Straighten the light with right hand so that it droop in the direction of your hand. See Figure 1. Side surface may not be bent or droop, See Figure 2.

**2. Assistant:**

Cooperate with the installer to lift the reel of the light, and then slowly deliver the light to installer. Do not pull or twist the light during the installation.

Installation precautions : Top mounted at height (2 person installation)

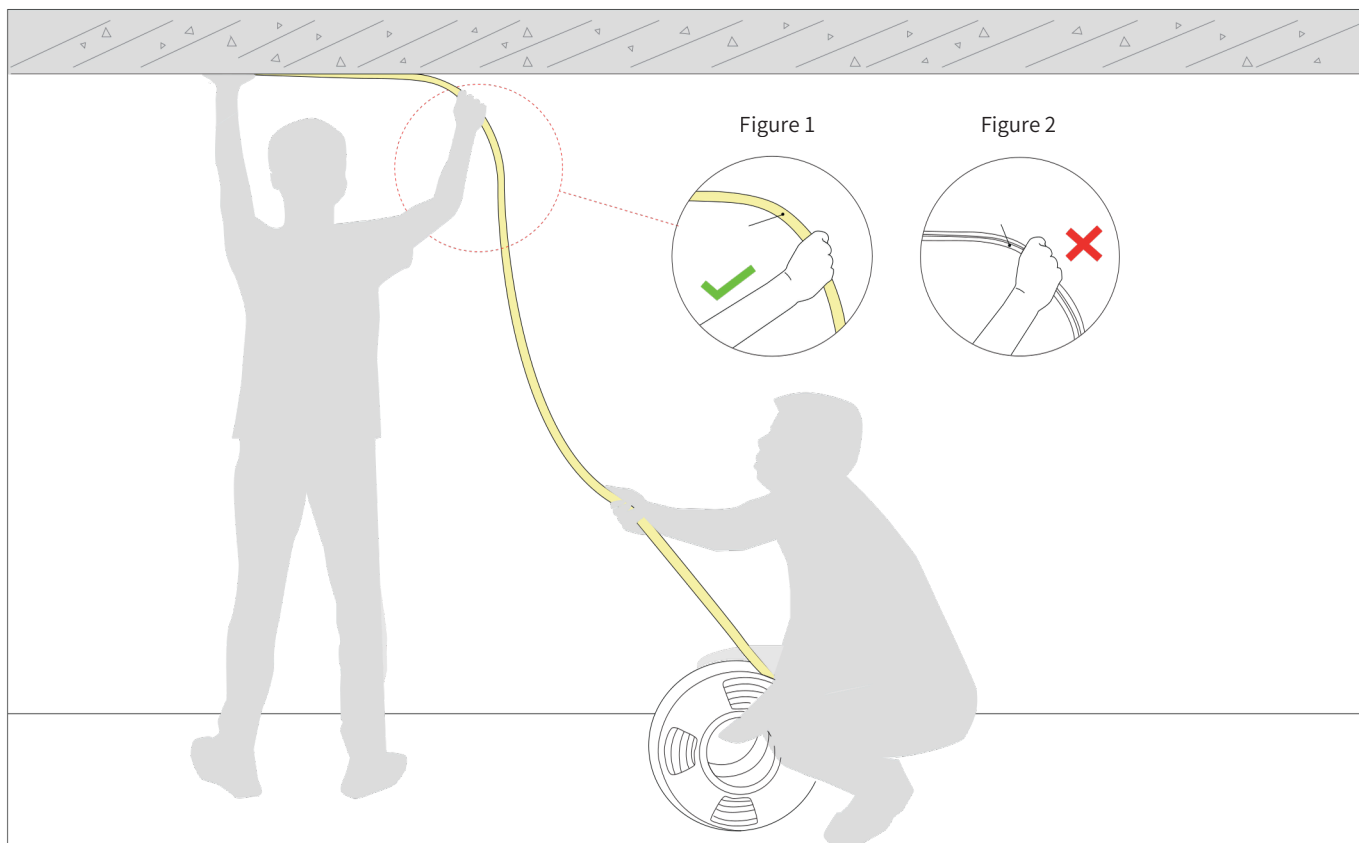

**1. Installer:**

1. Press the light with the palm of the left hand to slowly load it into the slot. Straighten the light with right hand so that it droop it in the direction of your hand. See Figure 1. Side surface may not be bent or droop, See Figure 2.

**2. Assistant:**

Cooperate with the installer to lift the reel of the light, and then slowly deliver the light to installer. Do not pull or twist the light during the installation.

Application Examples



Cable recommendations

The selection of the cable specification at the output end of the power supply, it depends on the total current of the load and the length of the cable. It is recommended to select according to the following table:

Current of the light	Specifications of the cable								
	L=1M	L=2M	L=4M	L=6M	L=8M	L=10M	L=12M	L=14M	L=16M
1A	AWG26	AWG23	AWG21	AWG18	AWG18	AWG17	AWG16	AWG15	AWG15
2A	AWG23	AWG21	AWG18	AWG16	AWG15	AWG14	AWG13	AWG12	AWG12
3A	AWG22	AWG18	AWG16	AWG14	AWG13	AWG12	AWG11	AWG11	AWG10
4A	AWG21	AWG18	AWG15	AWG13	AWG12	AWG11	AWG10	AWG9	AWG9
5A	AWG20	AWG17	AWG14	AWG12	AWG11	AWG10	AWG9	AWG9	AWG8
6A	AWG18	AWG16	AWG13	AWG11	AWG10	AWG9	AWG8	AWG8	AWG7
7A	AWG18	AWG15	AWG12	AWG11	AWG9	AWG8	AWG8	AWG7	AWG6
8A	AWG17	AWG15	AWG12	AWG10	AWG9	AWG8	AWG7	AWG7	AWG6
9A	AWG17	AWG14	AWG11	AWG10	AWG8	AWG7	AWG7	AWG6	AWG5
10A	AWG16	AWG14	AWG11	AWG9	AWG8	AWG7	AWG6	AWG6	AWG5

Warnings

- ⊗ The unused light should be sealed with the packaging bag to avoid prolonged exposure.
- ⊗ Please use DC24V isolated constant voltage power supply with ripple voltage less than 5%. Using other types of power supply may damage the light or cause other safety risks.
- ⊗ In practical application, 20% allowance should be reserved for power supply to ensure the stability of power supply.
- ⊗ It is recommended that professionals connect the power supply. Do not connect the power supply with live power to avoid electric shock.
- ⊗ Please confirm whether the voltage of the power supply is consistent with the voltage of the light; Pay attention to the positive and negative poles of the power cord, do not connect wrong, so as not to cause product damage;
- ⊗ When multiple power supplies are used, ensure that the positive poles of the power supply are not connected in parallel. Otherwise, the power supply system may be unstable or damaged after long-term operation.
- ⊗ If the actual application length exceeds the specified length, it will lead to overload, heating and uneven brightness of the light.
- ⊗ During installation, please do not scratch, twist, or bend the light irregularly. Otherwise, the light may be damaged beyond repair.
- ⊗ To ensure the life and reliability of the light, please do not over bend the light, which will damage the product itself.
- ⊗ To protect your eyes, please avoid staring at the glowing surface of the light for a long time.
- ⊗ Non-professionals are forbidden to install, disassemble and maintain the product.
- ⊗ Do not use any acid or alkaline adhesive to fix the light (including but not limited to glass glue, etc.)
- ⊗ IP67 products are not suitable for long-term immersion in water; IP68 products are only customized by the factory. After cutting and processing by users themselves, there is a risk that IP68 protection level cannot be reached
- ⊗ Because of the difference in structure, even if the same color temperature value, different sizes of light will look slightly different colors. Please confirm it before use.

Tests showed that methanol and benzenes will have yellowing effects on silicone.

In the newly decorated interior environment, epoxy floor paint, wall paint, wallpaper adhesive, various decoration materials or new furniture, they are likely to release of methanol and benzenes.

It is recommended to remove methanol and benzenes first, or ventilate for a period of time in the newly decorated interior environment before install the silicone neon light, to avoid affecting the silicone body.

# BE A TRUSTED LED STRIP MANUFACTURER

Email : [sales@yellowgrey.co.uk](mailto:sales@yellowgrey.co.uk)

Webiste : [www.yellowgrey.co.uk](http://www.yellowgrey.co.uk)

Trading Name : Yellow & Grey Limited

Registration number : 16034922

---